

Dist	COUNTY	ROUTE	POST MILES TOTAL PROJECT	SHEET No.	TOTAL SHEETS

REGISTERED CIVIL ENGINEER DATE \_\_\_\_\_

PLANS APPROVAL DATE \_\_\_\_\_

THE STATE OF CALIFORNIA OR ITS OFFICERS OR AGENTS SHALL NOT BE RESPONSIBLE FOR THE ACCURACY OR COMPLETENESS OF SCANNED COPIES OF THIS PLAN SHEET.



# STAGE CONSTRUCTION AND TRAFFIC HANDLING PLAN, EXAMPLE "70 SC-6"

- NOTES:**
- FOR ACCURATE RIGHT OF WAY DATA, CONTACT RIGHT OF WAY ENGINEERING AT THE DISTRICT OFFICE.
  - DRIVEWAY CONSTRUCTION: CONTRACTOR SHALL PROVIDE TEMPORARY ACCESS THROUGH THE WORK AT ALL TIMES.

**PWP:**  
Identify all PWPs being used on the project.  
Identify the location of PWP devices by Offset and Station (excludes Mobile Barrier System and Impact Attenuator Vehicles). Begin and End for the PWP devices shall follow the direction of stationing.

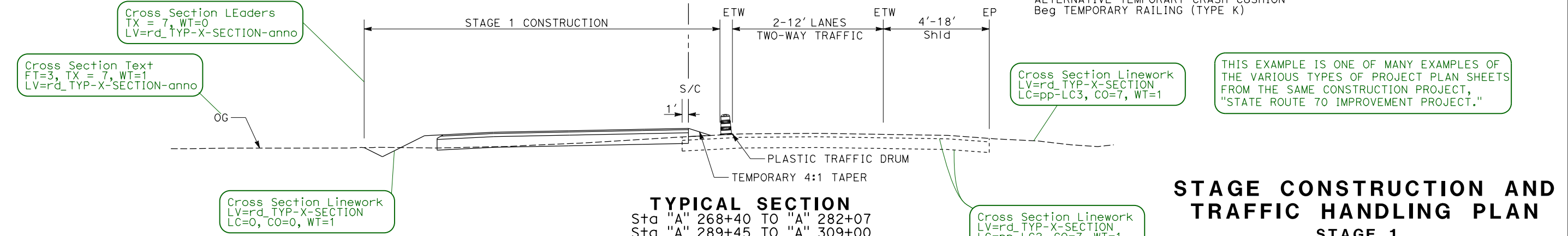
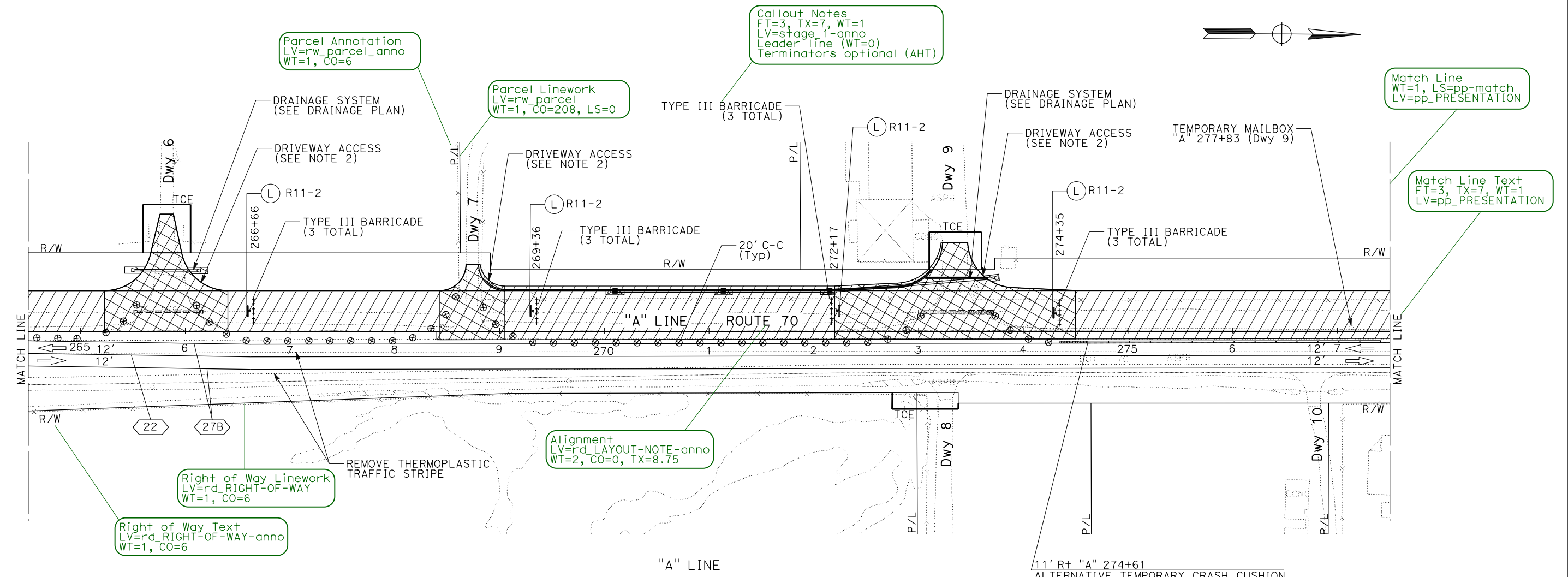

THIS EXAMPLE IS ONE OF MANY EXAMPLES OF THE VARIOUS TYPES OF PROJECT PLAN SHEETS FROM THE SAME CONSTRUCTION PROJECT, "STATE ROUTE 70 IMPROVEMENT PROJECT."

## STAGE CONSTRUCTION AND TRAFFIC HANDLING PLAN

STAGE 1  
SCALE: 1" = 50'

SC-6

APPROVED FOR STAGE CONSTRUCTION AND TRAFFIC HANDLING WORK ONLY

For additional typical information, refer to [Typical Cross Sections "Generic Sheet" with Instructions \(PDF\)](#)

STATE OF CALIFORNIA - DEPARTMENT OF TRANSPORTATION	FUNCTIONAL SUPERVISOR	CHECKED BY	REVISOR
Et-Trans			

STAGE CONST./ TRAFFIC HANDLING SHEET RELEASED 10/22/2021